

GEHRING ST.

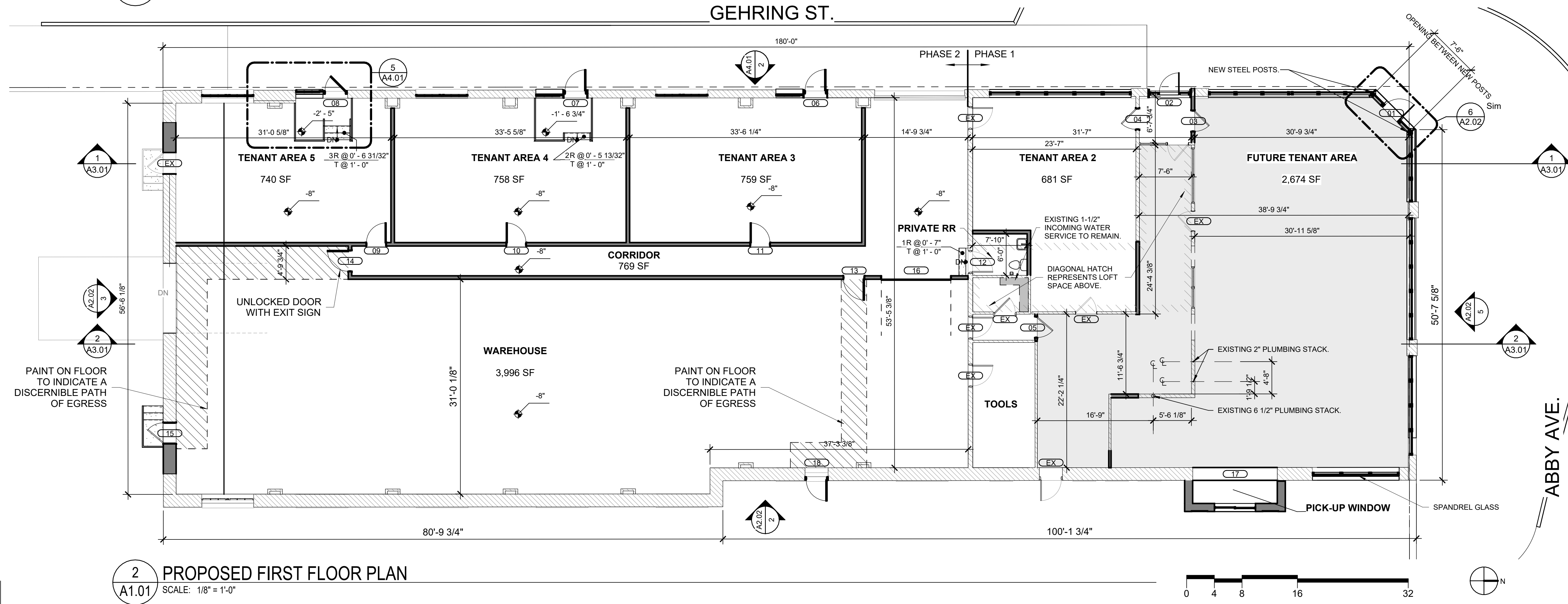

5. BRACE AND SUPPORT EXISTING WORK PRIOR TO AND DURING DEMOLITION AND NEW CONSTRUCTION UNTIL SAFE TO REMOVE SUCH BRACING AND SUPPORTS.
6. PIPES, CONDUIT, AND DUCTWORK ENCOUNTERED IN DEMOLISHED WALLS AND CEILINGS WHICH ARE TO REMAIN SHALL BE RE-ROUTED AND CONCEALED. THOSE WHICH ARE ABANDONED SHALL BE CAPPED AND CONCEALED IN THE WALLS OR CEILING.
7. REPAIR ALL DAMAGE TO EXISTING CONSTRUCTION CAUSED BY DEMOLITION. REPAIR TO MATCH ADJACENT CONSTRUCTION.
8. CLEAN AND PREPARE ALL SURFACES TO ACCEPT NEW WORK. THIS INCLUDES PATCHING AND REPAIRING ALL PENETRATIONS FROM REMOVED DUCTWORK, VENTS, DOOR FRAMES, ETC. ALL PATCHING AND NEW DRYWALL TO BE FLUSH AND MATCH EXISTING.
9. REMOVE WALLS WHERE INDICATED TO BE DEMOLISHED. WHERE NEW OPENINGS ARE CALLED OUT COORDINATE WITH LINTEL SCHEDULE PER STRUCTURAL DRAWINGS.
10. EACH TENANT SPACE TO BE SERVICED INDIVIDUALLY FOR ELECTRIC. HVAC MINI-SPLIT WITH ROOF CONDENSER FOR EACH.
11. SEE SHEET G0.02 FOR DOOR SCHEDULE.

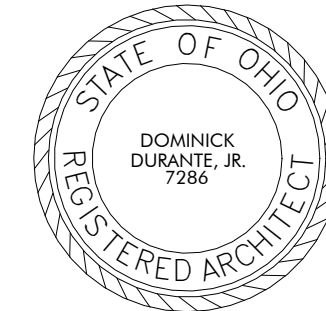

DOMINICK DURANTE, JR.  
LICENSE 07286  
EXPIRATION 12/31/2023

DO NOT SCALE DRAWINGS

Copyright © 2022 LDA architects Inc.  
This drawing and subject matter thereon, as well as associated specifications, constitute the original and unpublished work of, and are the instruments of service of, LDA architects, Inc. (LDA). For use solely with respect to this project. These instruments remain the exclusive property of LDA, who shall retain all common law, statutory and other reserved rights, including the copyright thereto, and may not be used, reproduced, copied, or altered, in whole or in part, for any purpose of project without the written consent of LDA.

## HISTORIC BRENNAN-HOGAN CO. REHABILITATION

2061 GEHRING AVE  
CLEVELAND, OH 44113

LDA Project No.2304

## FLOOR PLANS

## A1.01